

3. As provided in the provision to sub-section (9) of section 9 of the West Bengal Trees (Protection and Conservation in Non- Forest Areas) Act 2007, the plantation has to be implemented before the development project initiated; however, the developer is permitted to provide self-certificate of plantation undertaken as per sub-rule (1) of rule 7.
4. Formal permission for selling of trees on the land being developed, if necessary, be granted only after the sanction of building / construction plan;
5. This Certificate shall cease to be valid if the building / construction plan is rejected by the sanctioning authority or if the plantation work is not completed within the period as specified in the Condition No. 2 above.

Encls :- 1 (one) No. Approved
Plantation Plan



(Signature of the Competent Authority)

Name : MILAN KANTI MANDAL

Designation :
Divisional Forest Officer
Durgapur Division
S.S.

Official Seal :

No. 472/12-50

Dated, Durgapur, The 05/06/2018

Copy forwarded, to the Range Officer, Asansol (T.) Range with reference to his letter No. 115/AL-2 Dated 16.05.2018

Divisional Forest Officer
Durgapur Division
S.S.

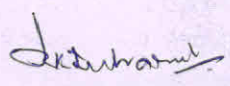
RAJENDRA KUMAR LUHARUWALA

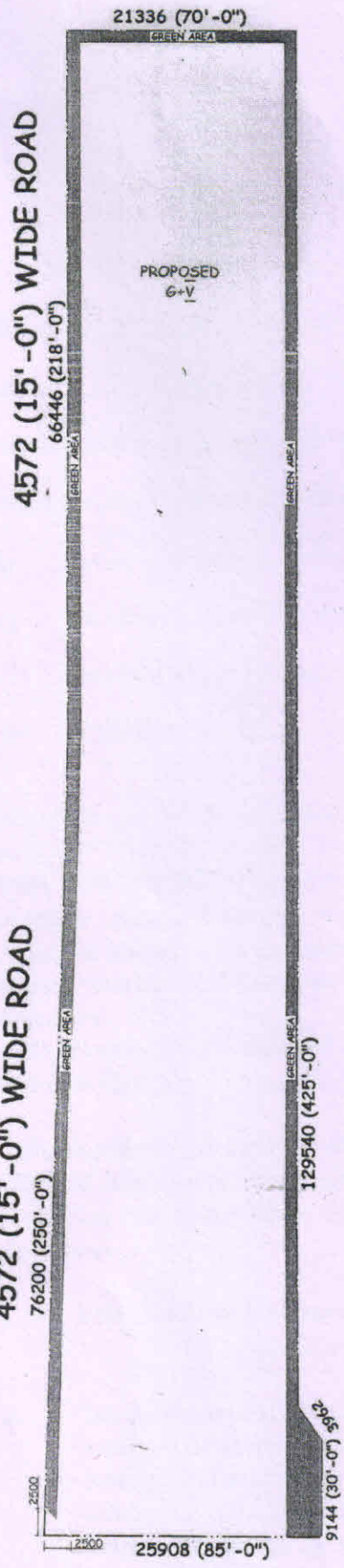

PLANTATION PLAN FOR PROPOSED G+V STORIED RESIDENTIAL BUILDING PLAN OF SRI RAJENDRA KUMAR LOHARUWALA S/O. RAMPRASAD LOHARUWALA TO BE CONSTRUCTED AT R.S. PLOT NO.- 570, R.S. KH. NO. -1799, CORROSPONDING L.R. PLOT NO.-1052, L.R KH. NO. -939, MOUZA- SEARSOLE, J.L. NO.- 17, BEARING HOLDING NO.-60, G.T. ROAD (EAST) P.S.-RANIGANJ, DIST.- PASHIM BURDHAMAN IN WARD NO.-33 (N), UNDER ASANSOL MUNICIPAL CORPORATION.

LAND AREA- (AS PER PARCHA) 78 SATAK	= 3157.40 sqm.
LAND AREA (AS PER SITE)	= 3157.40 sqm.
PERMISSIBLE GREEN AREA (20%)	= 631.48 sqm.
PROPOSED GREEN AREA	= 632.00 sqm.
NOS. OF TREES (6.25 SQM. PER TREE)	=101 NOS.

Minimum area of plantation
632 sq. mt i.e. 20% of total
land area 3157.40 sq. mt

Approved

[Signature]
Divisional Forest Officer
Durgapur Division
[Initials]

[Signature]
SIG. OF OWNER

RAJENDRA KUMAR LUHARUWALA

100 M WIDE G.T. ROAD (NH2)

PLANTATION PLAN
SCALE 1:150

[Signature]
Tapas Kumar Das
Bridget Architect & Engineer
Asansol Municipal Corporation
Lic. No 049/AMC/2018-2019
SIG. OF ENGINEER